

## SPECIFICATIONS

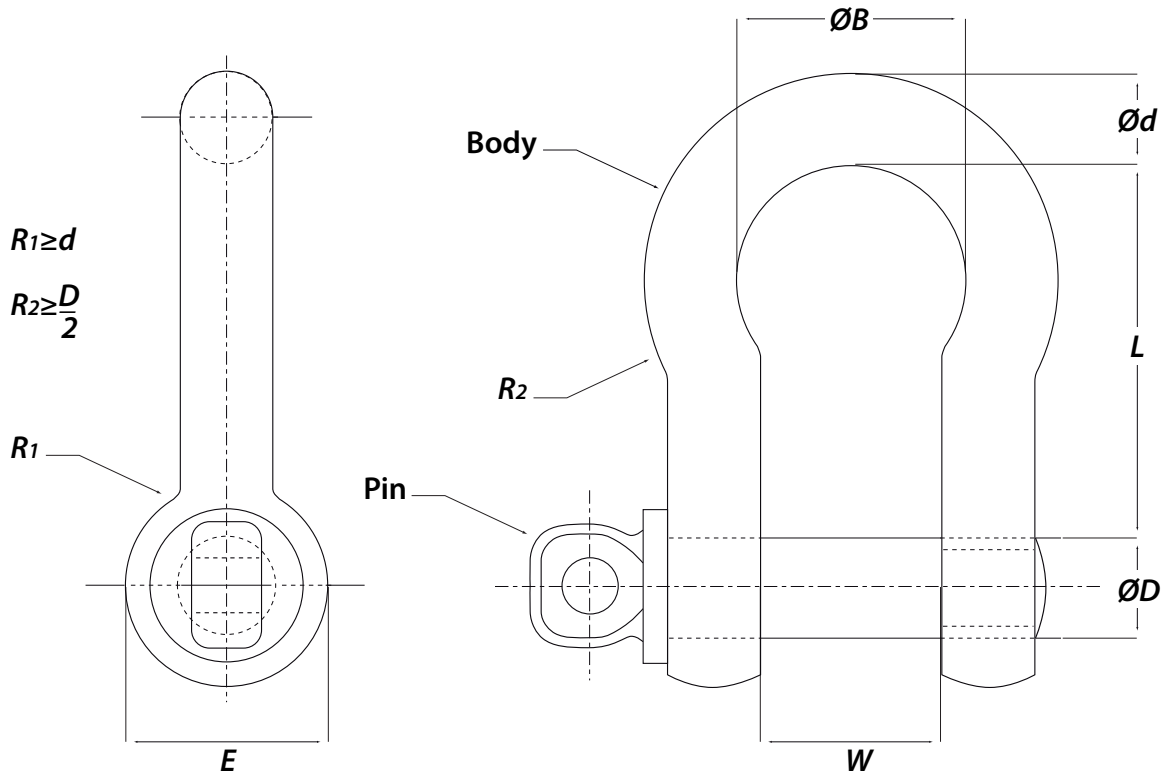

Product code	Nominal size mm	Dimension, mm (Tolerance +8%, .5%)						WLL t	Test Force, kN	
		$d$	$D$	$W$	$B$	$L$	$E$		Destructive test	Proof test
GOR-SH-S05	5	5	6	10	15	22	14	0.33	19.5	6.5
GOR-SH-S06	6	6	8	12	20	29	17	0.50	29.5	9.9
GOR-SH-S08	8	8	10	13	21	31	21	0.75	44.2	14.8
GOR-SH-S10	10	10	11	17	26	37	25	1.0	58.9	19.7
GOR-SH-S11	11	11	13	18	29	43	27	1.5	88.3	29.5
GOR-SH-S13	13	13	16	21	33	48	33	2.0	118	39.3
GOR-SH-S16	16	16	19	27	43	61	40	3.2	189	62.8
GOR-SH-S19	19	19	22	32	51	72	48	4.7	277	92.3
GOR-SH-S22	22	22	25	37	58	84	54	6.5	383	128
GOR-SH-S25	25	25	29	43	68	95	60	8.5	501	167